

## Electronic Superimposed Ignitors for HS Lamps 70 (DE) to 400 W and HI Lamps 35 to 400 W

Standard version or with automatic switch-off  
Compact shape

For high pressure sodium lamps (HS),  
metal halide lamps (HI) and  
ceramic discharge lamps (C-HI)

Ignition voltage: 4–5 kV

Phasing of the ignition voltage:

60–90 °el and 240–270 °el

Max. permitted casing temperature: 105 °C

Fastening: male nipple with pre-assembled  
washer and nut

For luminaires of protection class I and II

For luminaires of protection class I

(140594, 147707)

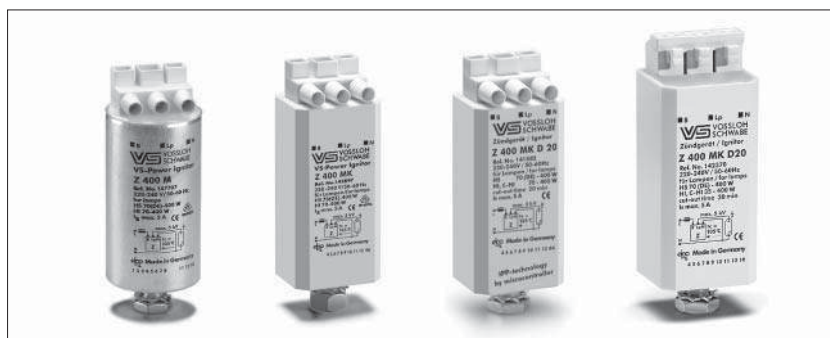

Al casing

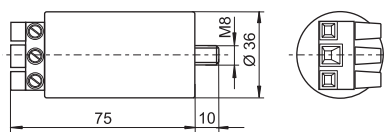

PC casing – K

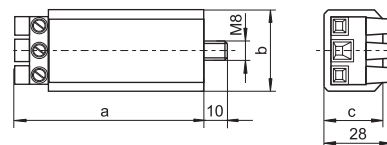

PC casing – K D20

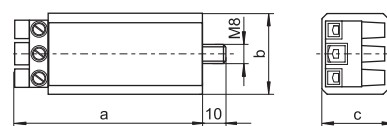

PC casing – with push-in terminals

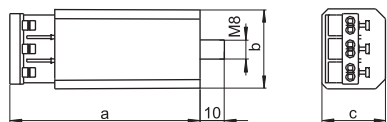

Type	Ref. No.	Voltage AC 50–60 Hz V	Max. lamp current A	Internal loss W	Inherent heating K	Ignition voltage kV	Load capacity pF	Switch-off time sec./Hz	Casing d (Ø) mm	a mm	b mm	c mm	Weight g
<b>Aluminium casing (Al) with screw terminals: 0.75–4 mm<sup>2</sup></b>													
Z 400 M	<b>140594</b>	220–240	5	< 3	< 35	4–5	20–50	—	35	76	—	—	140
Z 400 M VS-Power	<b>147707**</b>	220–240	5	< 3	< 35	4–5	20–50	—	35	76	—	—	140
Z 400 M S	<b>140693</b>	220–240	5	< 3	< 35	4–5	20–50	—	35	76	—	—	140
<b>Plastic casing (PC) with screw terminals: 0.75–4 mm<sup>2</sup></b>													
Z 400 M K	<b>140597</b>	220–240	5	< 3	< 35	4–5	20–50	—	—	78	34	27	130
Z 400 M K VS-Power	<b>142897**</b>	220–240	5	< 3	< 35	4–5	20–50	—	—	78	34	27	130
Z 400 M K D20	<b>141582*</b>	220–240	5	< 3	< 35	4–5	20–50	1216/50–60	—	80	34	30	145
<b>Plastic casing (PC) with push-in terminals: 0.5–2.5 mm<sup>2</sup></b>													
Z 400 M K D20	<b>142370*</b>	220–240	5	< 3	< 35	4–5	20–50	1216/50–60	—	83	34	30	145

Recommended for outdoor lighting

\* With IPP technology

\*\* Not suitable for C-HI lamps

## Electronic Superimposed Ignitors for HS and Hl Lamps 250 to 1000 W

Standard version or with automatic switch-off  
For high pressure sodium lamps (HS)  
and metal halide lamps (Hl)  
Phasing of the ignition voltage:  
60–90 °el and 240–270 °el  
Max. permitted casing temperature: 105 °C  
Screw terminals: 0.75–2.5 mm<sup>2</sup>  
(Z 1000 S: 0.75–4 mm<sup>2</sup>)  
Fastening: male nipple with pre-assembled  
washer and nut  
For luminaires of protection class I and II

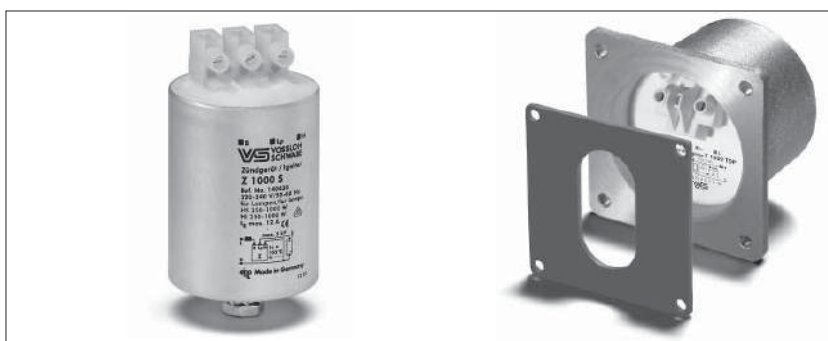

Al casing

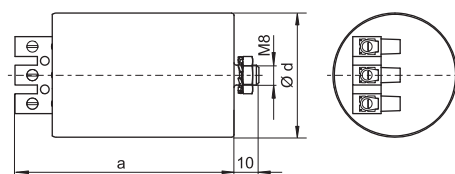

Z 1000 TOP

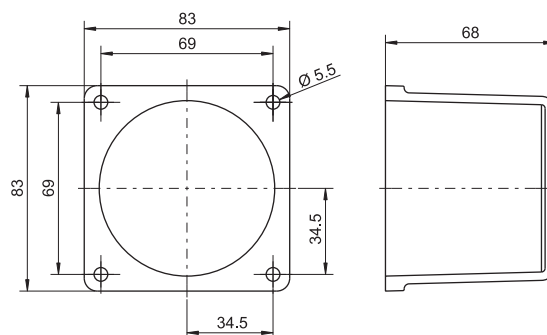

Type	Ref. No.	Voltage AC 50–60 Hz V	Max. lamp current A	Internal loss W	Inherent heating K	Ignition voltage kV	Load capacity pF	Switch-off time sec./Hz	Casing d (Ø) mm	a mm	b mm	c mm	Weight g
<b>Aluminium casing (Al)</b>													
Z 1000 S	<b>140430</b>	220–240	12	< 6	< 35	4–5	20–100	—	50	80	—	—	340
Z 1000 TOP	<b>140607**</b>	220–240	12	< 6	< 35	4–5	20–100	—	—	83	83	68	620
Z 1000 S D20	<b>141584*</b>	220–240	12	< 6	< 35	4–5	20–100	1216/50–60	50	80	—	—	340

\* With IPP technology

\*\* For flange-mounting with gasket for degree of protection IP55

## Electronic Superimposed Ignitors for HS Lamps 600 and 750 W

Standard version

For high pressure sodium lamps (HS)

Phasing of the ignition voltage:

60–90 °el and 240–270 °el

Max. permitted casing temperature: 105 °C

Screw terminals: 0.75–4 mm<sup>2</sup>

Fastening: male nipple with pre-assembled washer and nut

For luminaires of protection class I and II



**Al casing**

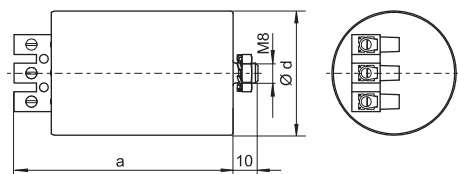

Type	Ref. No.	Voltage AC 50–60 Hz V	Max. lamp current A	Internal loss W	Inherent heating K	Ignition voltage kV	Load capacity pF	Switch-off time sec./Hz	Casing				Weight g
									d (Ø) mm	a mm	b mm	c mm	
Aluminium casing (Al)													
Z 750 S	146990	220–240	8	< 3	< 20	4–5	20–100	—	50	90	—	—	360



## מצת פולסר מתוכנת ES-PI 1000 220-250V / 50-60Hz



מתאים לכל סוגי הנורות נל"ג ומ"ה בתחום הספקים 35-1000W להפעלה עם משגקי עין השופט הכוללים סנף הצתה מאפשר הצתה מרוחקת (עומס מרבי של 1000pF כ-12 מטר) מנגנון חכם להגנה על הציוד:

- מנגנון לזיהוי נורה שרופה או חוסר בנורה
- הפסקת ניסיונות הצתה אחרי 20 דקות (טיימר)
- הצתה באינטרוולים להארכת חיי הנורה (5 שניות ניסיון, 55 שניות המתנה)

- מזהה ומונע Cycling

מהדקים בורגיים למוליכים בחתך  $0.75-2.5\text{mm}^2$

תו תקן ישראלי:

ת"י 61347-2.1

ת"י 60927

3 שנות אחריות

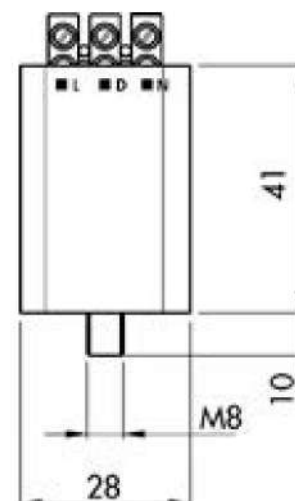
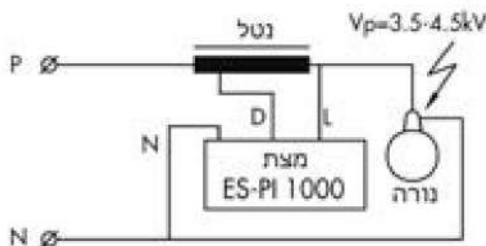

סוג	מק"ט	יחס סניפה	מתח שיא הפולס	קצב הפולסים	מיקום הפולסים	קיבול עומס מירבי	מתח תגובה	מתח ניתוק	הפסדים	$t_a\text{max}$	$t_c\text{max}$	נורות	
												נל"ג	מ"ה
			kV		°E	pF	Vac	Vac	W	°C	°C	W	W
ES-PI 1000	730	6%	3.5-4.5	2 / cycle	60-90	1000	180	170	0.2	85	90	35-1000	35-1000